

How to pair a LINAK® Wireless handset



Double confirmation
beep - Pairing OK



Beep
Beep

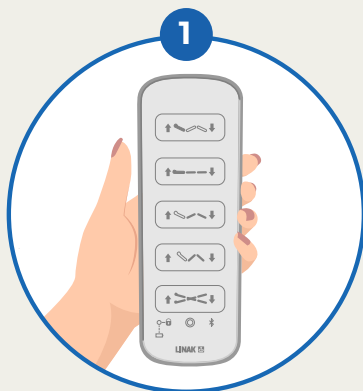

Move within two meters of
the bed / application

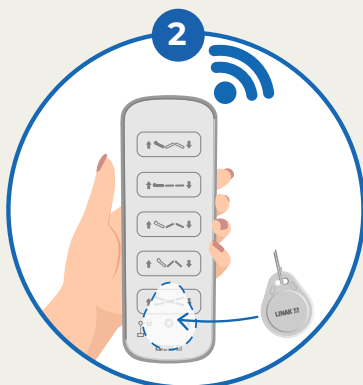

Enter Direct Pairing Mode by
activating key 1 and magnet
in 3 seconds.



Release key and magnet
and move closer to control
box until buzzer frequency
change from slow to fast.

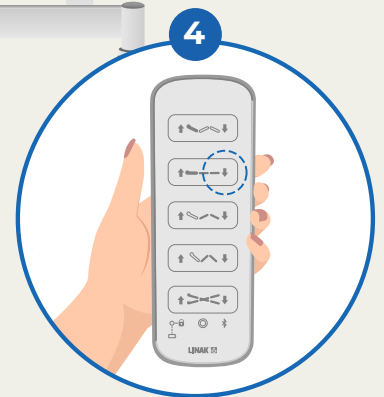

Confirm pairing by
pushing key 1