



DESK SENSOR™ 1

Data sheet

DESK SENSOR™ 1

The Desk Sensor™ 1 (DS1) is an Anti-Collision™ solution which can limit material damage to a desk or an object if a collision occurs during driving of the desk. The DS1 is a small, compact plug-in adapter based on gyroscope-technology, and it detects even little tilting of the desk when the desk is driving up or down. Upon detected tilting, the system stops and drives in the opposite direction to avoid collision and damage to the desk or the object. The DS1 can detect both hard and soft obstacles. The DS1 is compatible with all DESKLINE® systems based on Control Box CBD6S and with DL IC systems (Integrated Controller) and works with both 2-part and 3-part columns. Up to four DS1 devices can be connected in series (daisy chain) to one system and used for large desks.

Optionally, the DS1 can also be combined with the well-known PIEZO™ technology ensuring an even higher level of anti-collision. The DS1 is highly sensitive, stable and works independently of load and temperature. Protects what matters.



Features:

- Minimises the risk of damage to a desk caused by squeezing or blocking of obstacles in up and down direction
- Daisy chain of up to four DS1 devices (as of DS1 software SW03004001 version 1.13) connected to CBD6S with software SW03003051 version 1.00
- Reacts to angle changes bigger than 0.7° per second
- Small and compact size
- Just plug it in – no mounting required
- ZERO™ Power capable
- PVC-Free™
- Compatible with:
 - all standard DESKLIFT™ columns when using Control Box CBD6S
 - all DESKLIFT™ columns with Integrated Controller (IC) when using an RJ45 T-splitter and a serial cable for connecting the DS1
 - DESKLIFT™ columns featuring PIEZO™ for an even higher level of anti-collision
 - the LINAK Anti-Collision™ software for an even higher level of anti-collision

Usage:

- Ambient temperature: 5 to 40 °C
- Storage and transportation temperature: -40 to +70 °C



The DS1 can only be used with compatible LINAK products.



The DS1 is compatible with CBD6S with software SW03002000 version 1.63 and later and IC column with software SW03002002 version 1.13 and later. For daisy chain configuration, CBD6S software SW03003051 version 1.00 is required.



The DS1 is not compatible with special software for CBD6S and IC columns.

Desk Sensor 1 - DS1

Ordering example:

The DS1 is available as a separate article in bags of 10 pieces.

The T-splitter is available as a separate article in bags of 16 pieces.

Order code	Product
DESKSENSOR1-000*	Desk Sensor™ 1
TSPLIT-00**	RJ45 T-splitter
0705835	Serial cable, black, 300 mm
0705831	Serial cable, black, 1000 mm
0965167	Serial cable, black, 1500 mm
0617503	Serial cable, black, 2000 mm

*: Please order DESKSENSOR1-000 in quantities of 10 pieces; 100 pieces fit in one box.

** : Please order TSPLIT-00 in quantities of 16 pieces; 768 pieces fit in one box.

**Dimension drawing
Desk Sensor 1 - DS1**

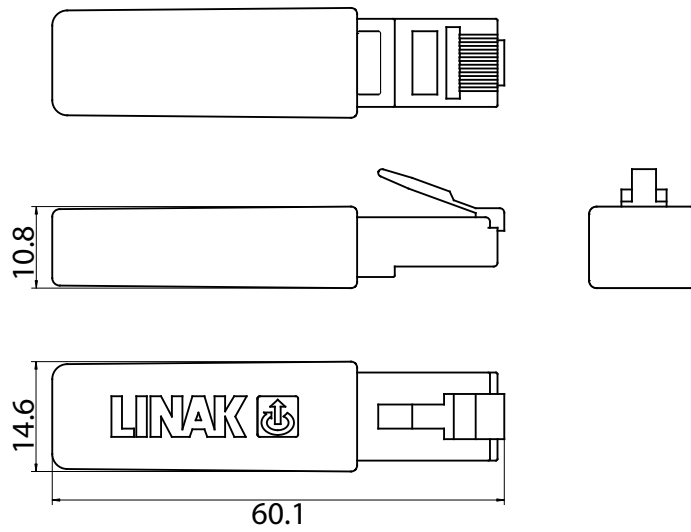

**Dimension drawing
T-splitter**

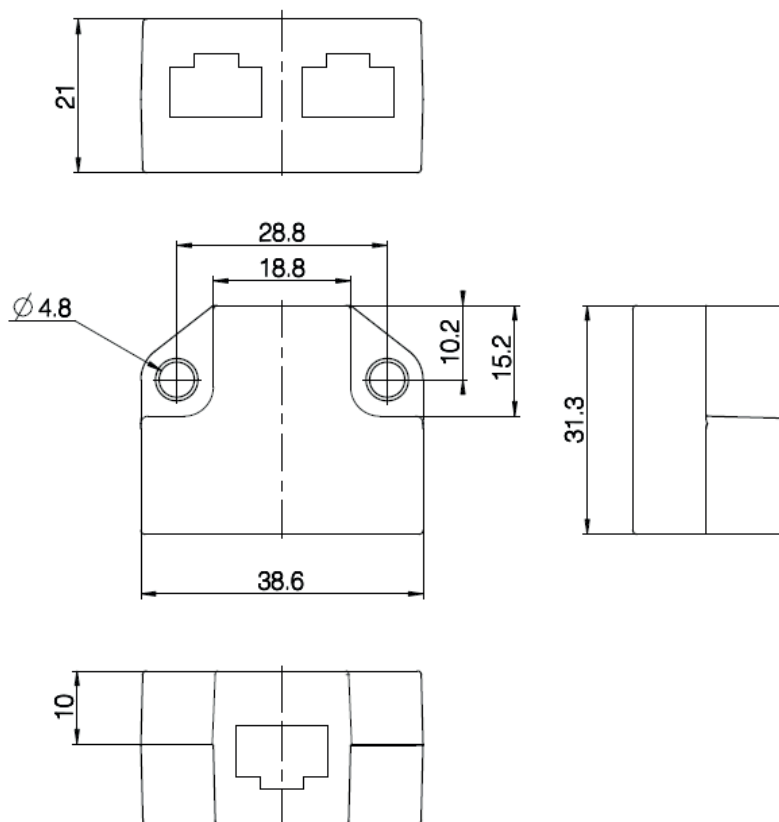

LINA K® accepts no responsibility for possible errors or inaccuracies in catalogues, brochures, and other material. LINA K reserves the right to change its products without prior notice. LINA K cannot guarantee product availability and reserves the right to discontinue the sale of any product. The user is responsible for determining the suitability of LINA K products for a specific application. All sales are subject to the 'Standard Terms of Sale and Delivery', available on LINA K websites.

LINA K and the LINA K logotype are registered trademarks of LINA K A/S. All rights reserved.