

Linear Actuator LA76

User Manual



Contents

Preface	3
Terms of use	4
Introduction	5
Safety instructions	5
Features	7
Options in general	7
Usage	8
B10 Lifetime prediction	9
Intermittence	10
Speed and current curves	11
Mounting guidelines	13
Built-in dimensions	15
Keep a clearance when mounting a bracket	15
Electrical installation	15
Current limits	17
Cable mounting	18
Cable mounting	19
Label for LA76	21
Maintenance	22
Repair	22
Main groups of disposal	22
Warranty	22
Declaration of Conformity	23
Declaration of Incorporation of Partly Completed Machinery	25
Contacts	26

Preface

Dear User,

We are delighted that you have chosen a LINAK® product.

LINAK systems are high-tech products based on many years of experience in the manufacture and development of actuators, lifting columns, desk frames, electric control boxes, controls, batteries, accessories and chargers.

This User Manual does not address the end user. It is intended as a source of information for the equipment or system manufacturer only, and it will tell you how to install, use and maintain your LINAK electronics. The manufacturer of the end product has the responsibility to provide a User Manual, where relevant safety information from this manual is passed on to the end user.

We are convinced that your LINAK product/system will give you many years of problem-free operation.

Before our products leave the factory, they undergo both function and quality testing. Should you, nevertheless, experience problems with your product/system, you are always welcome to contact your supplier.

LINAK subsidiaries and some distributors situated all over the world have authorised service centres, which are always ready to help you. Locate your local contact information on the back page.

LINAK provides a warranty on all products. (See warranty section).

This warranty, however, is subject to correct use in accordance with the specifications, maintenance being done correctly, and any repairs being carried out at a service centre, which is authorised to repair LINAK products.

Changes in installation and use of LINAK systems can affect their operation and durability. The products may only be opened by authorised personnel.

This User Manual has been written based on the present technical knowledge. LINAK reserves the right to carry out technical modifications and keeps the associated information updated.

LINAK A/S

Terms of use

LINAK® takes great care in providing accurate and up-to-date information on its products. However, the user is responsible for determining the suitability of LINAK products for a specific application.

Due to continual development, LINAK products are subject to frequent modifications and changes. LINAK reserves the rights to conduct modifications, updates, and changes without any prior notice. For the same reason, LINAK cannot guarantee the correctness and actual status of imprinted information on its products.

LINAK uses its best efforts to fulfil orders. However, for the reasons mentioned above, LINAK cannot guarantee availability of any particular product at any given time. LINAK reserves the right to discontinue the sale of any product displayed on its website or listed in its catalogues or in other written material created and produced by LINAK, LINAK subsidiaries, or LINAK affiliates.

All sales are subject to the 'Standard Terms of Sale and Delivery for LINAK A/S' available on LINAK websites.

LINAK and the LINAK logotype are registered trademarks of LINAK A/S. All rights reserved.

Introduction

Versatile electric linear actuator that delivers both robustness and long-term reliability. It excels in challenging environments and is a wise choice for a wide array of industrial machinery and applications that require high-level performance.

Safety instructions

Please read this safety information carefully.

Be aware of the following three symbols throughout the document:



Warning!

Failing to follow these instructions can cause accidents resulting in serious personal injury.



Recommendations

Failing to follow these instructions can result in the actuator suffering damage or being ruined.



Additional information

Usage tips or additional information that is important in connection with the use of the actuator.

Furthermore, ensure that all staff who are to connect, mount, or use the actuator are in possession of the necessary information and that they have access to this document.

Persons who do not have the necessary experience or knowledge of the product/products must not use the product/products. Besides, persons with reduced physical or mental abilities must not use the product/products, unless they are under surveillance or they have been thoroughly instructed in the use of the apparatus by a person who is responsible for the safety of these persons.

Moreover, children must be under surveillance to ensure that they do not play with the product.

Before you start mounting/dismounting, ensure that the following points are observed:

- The actuator is not in operation.
- The actuator is free from loads that could be released during this work.

Before you put the actuator into operation, check the following:

- The actuator is correctly mounted as indicated in the relevant user instructions.
- The equipment can be freely moved over the actuator's whole working area.
- The actuator is connected to a mains electricity supply/transformer with the correct voltage and which is dimensioned and adapted to the actuator in question.
- Ensure that the voltage applied matches to the voltage specified on the actuator label.
- Ensure that the connection bolts can withstand the wear.
- Ensure that the connection bolts are secured safely.

During operation, please be aware of the following:

- Listen for unusual sounds and watch out for uneven running. Stop the actuator immediately if anything unusual is observed.
- Do not sideload the actuator.
- Only use the actuator within the specified working limits.
- Do not step on or kick the actuator.

When the equipment is not in use:

- Switch off the mains supply in order to prevent unintentional operation.
- Check regularly for extraordinary wear.

Classification

The equipment is not suitable for use in the presence of a flammable anaesthetic mixture with air or with oxygen or nitrous oxide.

Warnings

- Do not sideload the actuator.
- When mounting the actuator in the application ensure that the bolts can withstand the wear and that they are secured safely.
- If irregularities are observed, the actuator must be replaced.

**Recommendations**

- Do not place load on the actuator housing.
- Prevent impact or blows, or any other form of stress to the housing.
- Ensure that the cable cover is mounted correctly. Use 3.5 Nm torque.
- Ensure that the duty cycle and the usage temperatures for LA76 actuators are respected.
- Ensure that the cable cannot be squeezed, pulled or subjected to any other stress.
- Furthermore, it will be good practice to ensure that the actuator is fully retracted in the "normal" position. The reason is that there will be a vacuum inside the actuator if it is extended which over time can lead to water entering the actuator.

Features

- Protection class: IP66 for outdoor use (dynamic). Furthermore, the actuator can be washed down by a high pressure cleaner (IP69K - static)
- Highly efficient acme thread spindle
- Safety factor 2: The actuator has been certified to withstand static loads that are twice the magnitude of its dynamic load capacity without sustaining damage.
- Hand crank for manual operation
- Stroke length from 75 to 1200 mm (in steps of 5 mm)
- Integrated brake with high self-lock ability
- Endplay: max. 3.5 mm
- Non-rotating piston rod eye
- Noise level: 73 dB (A). Measuring method: DS/EN ISO 3746 (actuator not loaded)
- Built-in Zero Point positioning
- Heavy duty aluminium housing for harsh conditions
- Hall effect sensor for precise positioning
- Current monitoring
- Weight: 4.29 kg for 100 mm stroke; Additional 0.24 kg for each additional 50mm stroke.
(Cable not included; weight varies by selected options)

Options in general

- 24 / 48 V DC Brushless motor
- Load from 500 N - 6,800 N depending on gear ratio and spindle pitch
- Max. speed 142 mm/sec. depending on gear ratio and spindle pitch
- Back fixture turnable in steps of 30 degrees
- Exchangeable cables in different lengths
- When ordering AISI (304 and up) piston rod eye and back fixture, stainless steel screws are automatically included
- Endstop reached signals
- IC options including:
 - I/O
 - Ethernet/IP
 - Modbus TCP/IP
 - Modbus RTU
 - IO-Link
 - CAN SAE J1939
 - CANopen
 - PROFINET
- Specific interface user manuals are available at the [TECHLINE webpage](#) containing both Connection Diagrams and I/O Specifications
- PC configuration tool (Actuator Connect™)

Usage

- Duty cycle up to 600 mm stroke: max. 20% (240 s drive and 960 s rest)
- Duty cycle at 601-999 mm stroke: max. 15% (180 s drive and 1020 s rest)
- Duty cycle at 1,000-1,200 mm stroke: max. 10% (120 s drive and 1080 s rest)
- Ambient operating temperature: Full performance from +5 °C to +40 °C
-30 °C (reduced load 50%) to + 85 °C (reduced duty cycle 10%)
-40 °C (no load)
- Storage temperature: -40 °C to +70 °C
(Actuator is not activated/connected) -40 °C to +85 °C for 72 hours
-55 °C to +105 °C for 24 hours
Acclimatization before usage.
- Relative humidity: Full performance from 20 % to 80 % - non-condensing
(Actuator is not activated/connected)
- Cyclic state: 93 % to 98 % - non-condensing +25 °C to +55 °C for 12 hours
- Steady state: 93 % to 95 % - non-condensing +40 °C for 56 Days
- Atmospheric pressure: 700 to 1060 hPa
- Meters above sea level: Max. 3000 meters

B10 Lifetime prediction

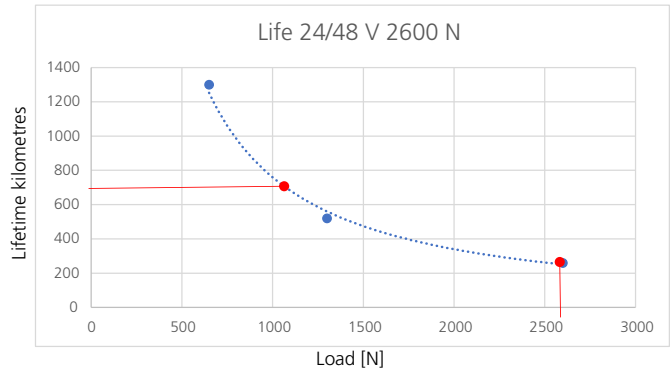
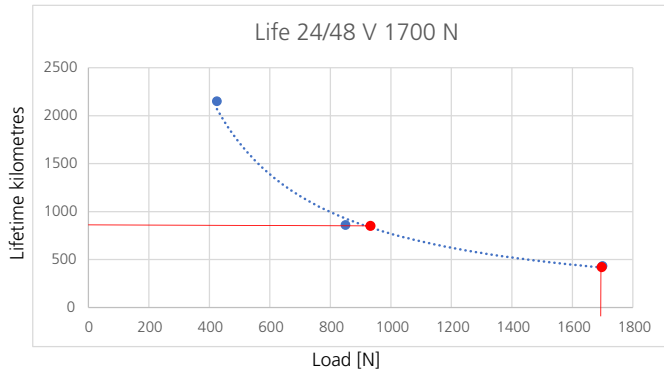
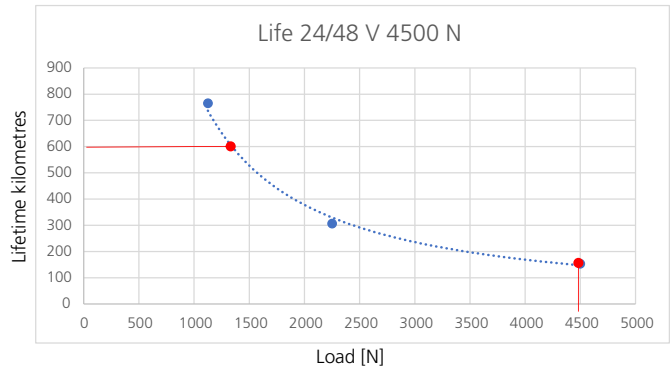
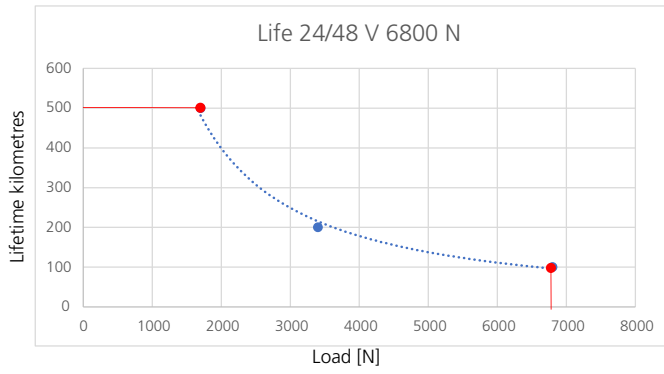

Intermittence

Because the motor and drive within the actuator/lifting column produce heat during operation, the actuator/lifting column needs pauses to avoid excessive wear and overheating.

Intermittence is the ratio between the time when the actuator/lifting column is in motion and when it is paused.

The duty cycle stated in 'Usage' is the intermittence with which the device can be used within the defined 'Operation temperature range' at full load without overheating.

The ratio can be altered with changes to the load and/or changes in the ambient temperature.

Above 40°C: max. 2 minutes continuous run.

Below 40°C: max. 4 minutes continuous run.

The curve describes the duty cycle in % with a given load in a specific ambient temperature.

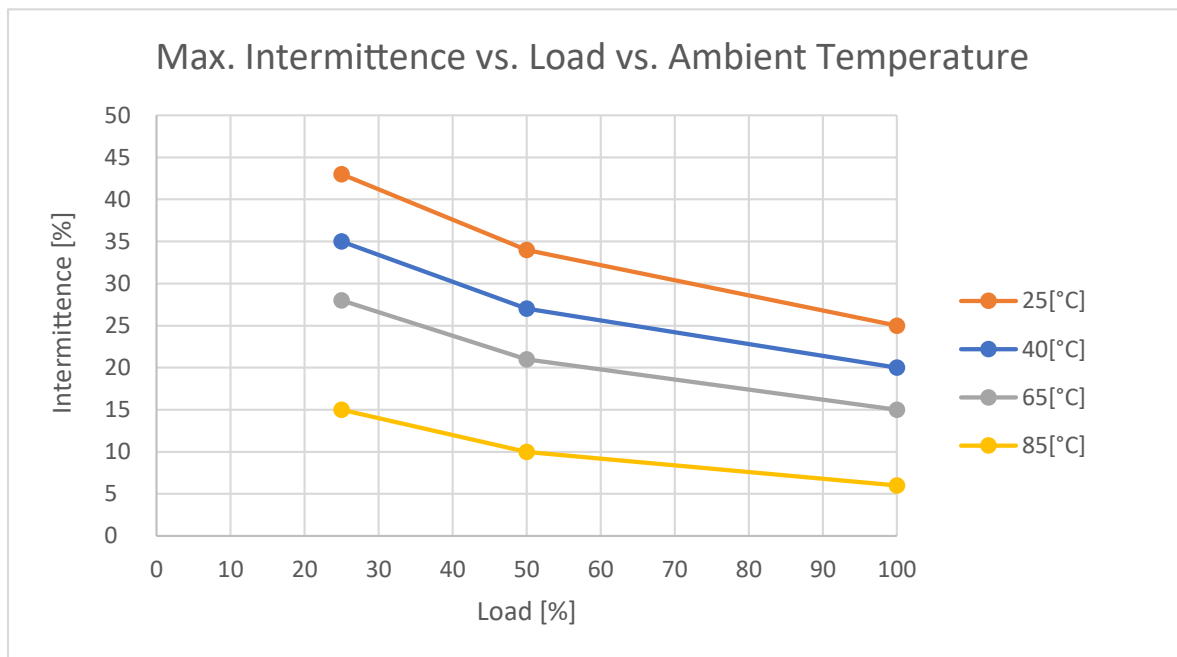

Speed and current curves

The values below are typical values and made with a stable power supply and an ambient temperature of 20°C.

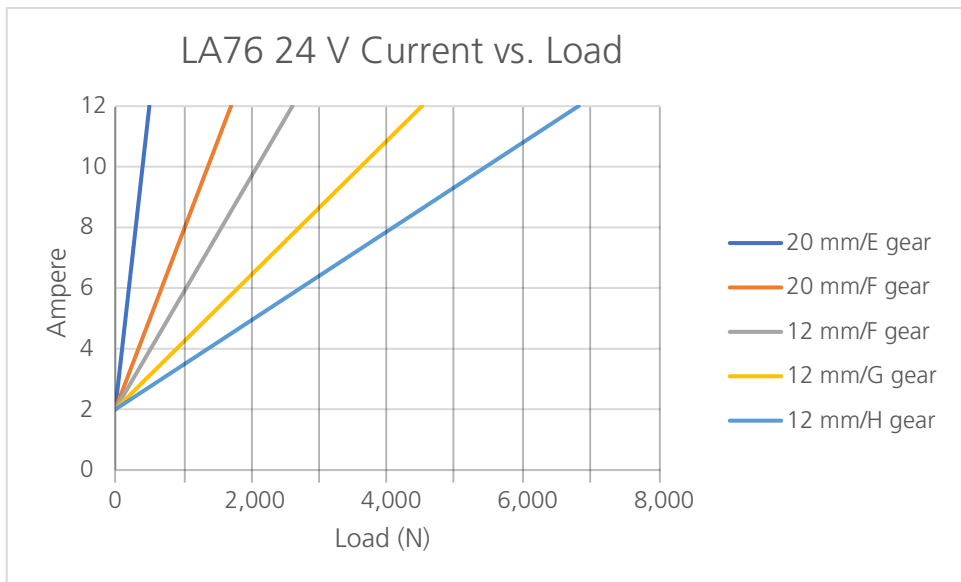
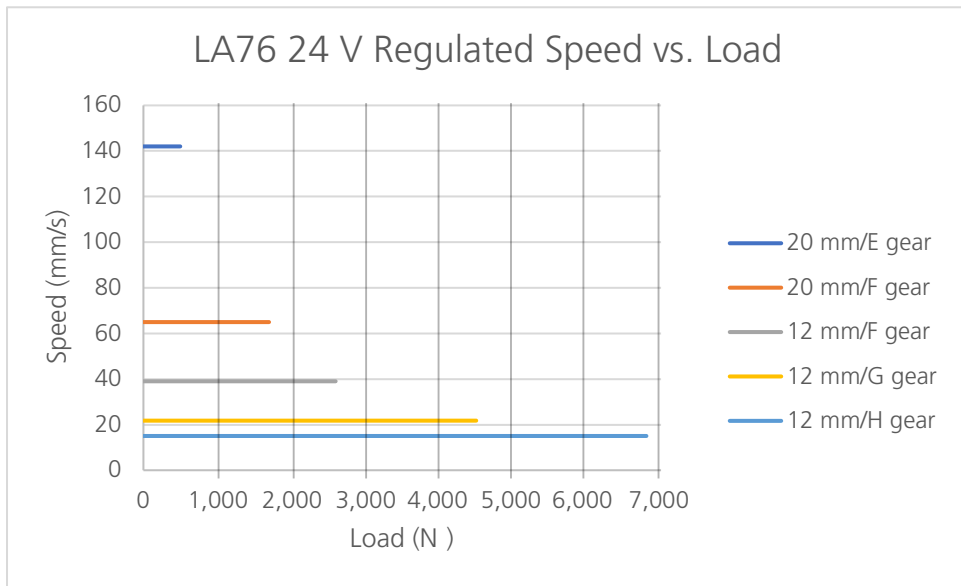

Speed and current curves

The values below are typical values and made with a stable power supply and an ambient temperature of 20°C.

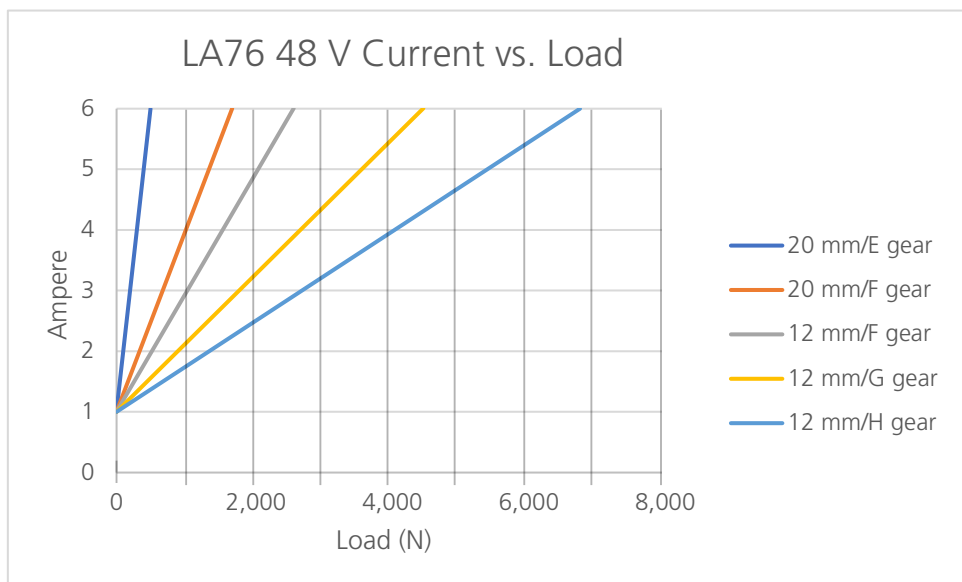
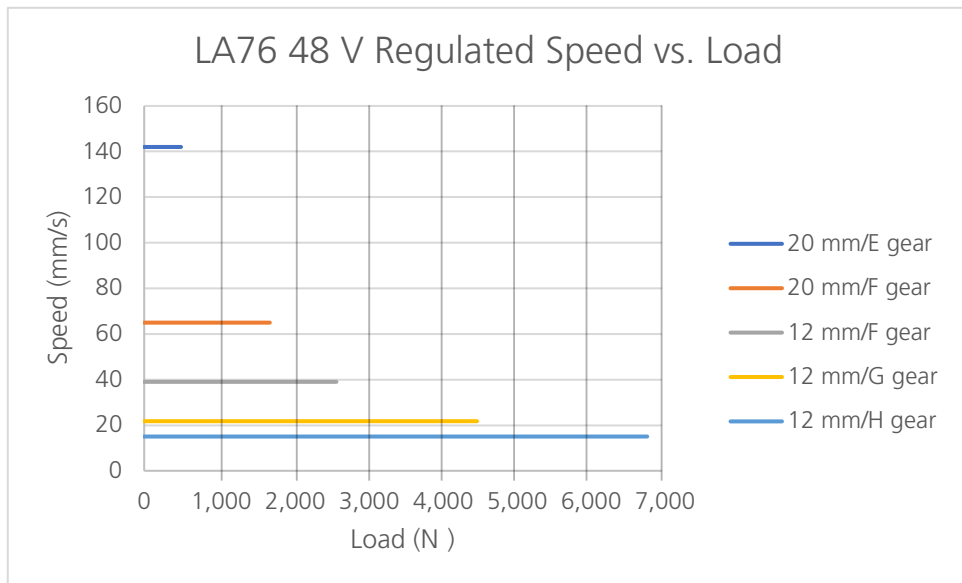

All measurements above describe the spindle pitch (e.g. 20mm) and the gear type (e.g. H gear) of the actuator.

Mounting guidelines

LINAK® linear actuators are quickly and easily mounted by slipping pins through the holes on each end of the units and into brackets on the machine frame and the load.

The mounting pins must be parallel to each other as shown below. Pins, which are not parallel to each other, may cause the actuator to bend and be damaged.

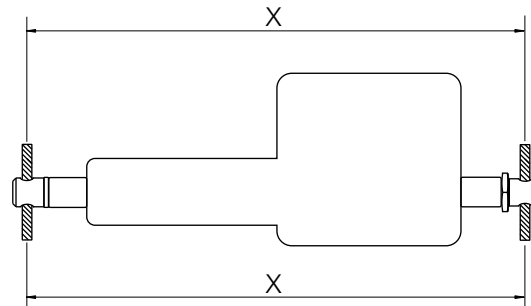

The load should act along the stroke axis of the actuator since off centre loads may cause bending and lead to premature failure. See Figure below.

Support both ends of the mounting pins. Failure to do so could shorten the life of the actuator. Do not use mounts that support the actuator on one side only.

The actuator can rotate around the pivot point in the front and rear end. If this is the case it is of high importance that the actuator is able to move freely over the full stroke length, both during the development and during daily operation. Please pay special attention to the area around the housing where parts can be trapped and cause damages to the application and actuator.

In applications with high dynamic forces LINAK recommends not to use the fully extended or retracted position over longer time, as this can damage the endstop system permanently.

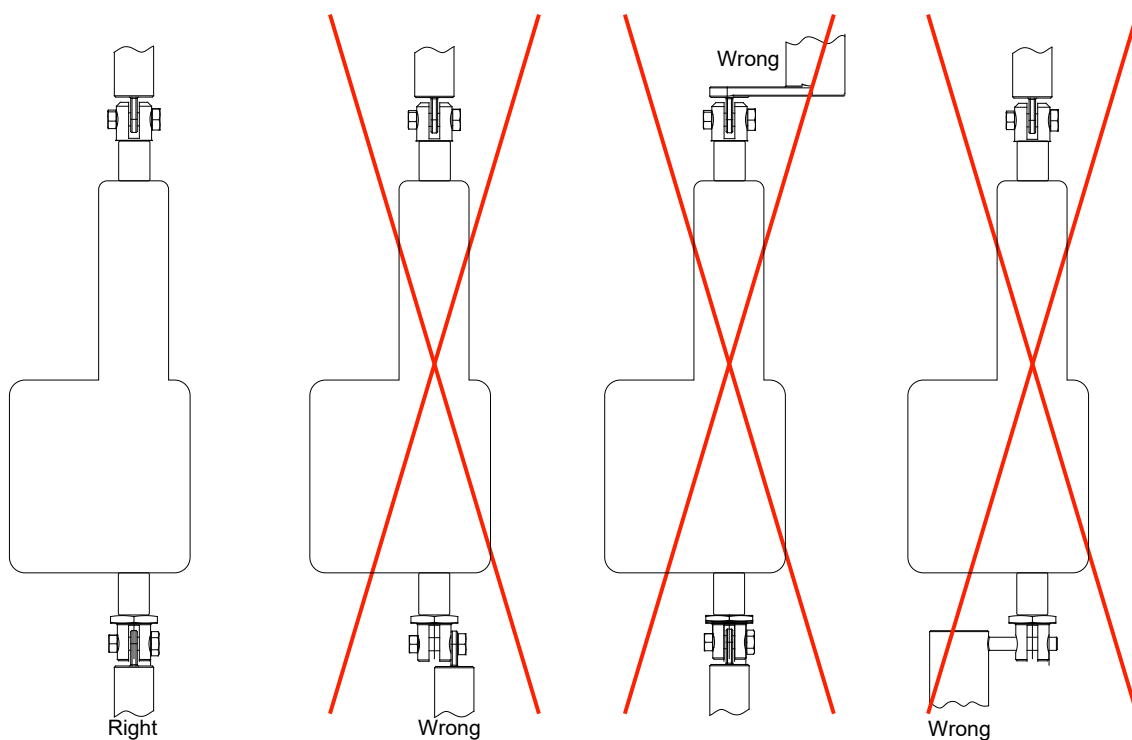

Please note that if the actuator is used in applications where there is moisture, it is recommended to mount the actuator with the motor housing facing upwards and the wires pointing downwards.

Mounting guidelines

- The mounting pins must have the correct dimension
- The bolts and nuts must be made of a high quality steel grade (e.g. 10.8). No thread on the bolt inside the back fixture or the piston rod eye
- Bolts and nuts must be protected so there is no risk for them to fall out
- Do not use a torque that is too high when mounting the bolts for the back fixture or the piston rod eye. This will stress the fixtures
- If the actuator for some reason does not fit the application, drive the actuator in or out using electric power. DO NOT use excessive force, e.g. a hammer or similar tools, to make the actuator fit the application



Please note:

The piston rod eye is only allowed to turn 0-180 degrees.

Instruction concerning the turning of the piston rod eye and inner tube:

- When mounting and taking into use, it is not permitted to make excessive turns of the piston rod eye. In cases where the eye is not positioned correctly, it is permitted to first screw the eye down to its bottom position, at a maximum torque of 2 Nm (1), and thereafter a maximum 180 degrees turn outwards again (2)
- As the piston rod eye can turn freely, it is important to ensure that the eye cannot rotate if the actuator is used in a pull application. If this happens, the actuator will be pulled apart and destroyed

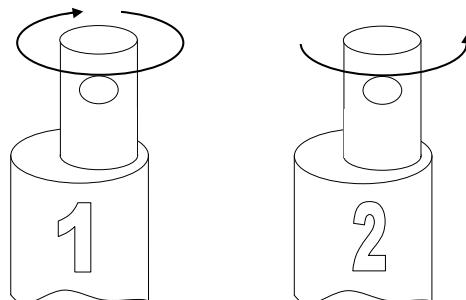

Warning!

If the actuator is used for pull in an application where personal injury can occur, the following is valid:

It is the application manufacturer's responsibility to incorporate a suitable safety arrangement, which will prevent personal injury from occurring, if the actuator should fail.



Warning!

LINAK actuators are not designed for use within the following fields:

- Explosive environments
- Nuclear power generation
- Aeroplanes and other aircraft



Scope for offshore applications: Only if the LINAK® product is not used in the operation of the offshore platform or similar offshore property.

Built-in dimensions

All dimensions are in mm

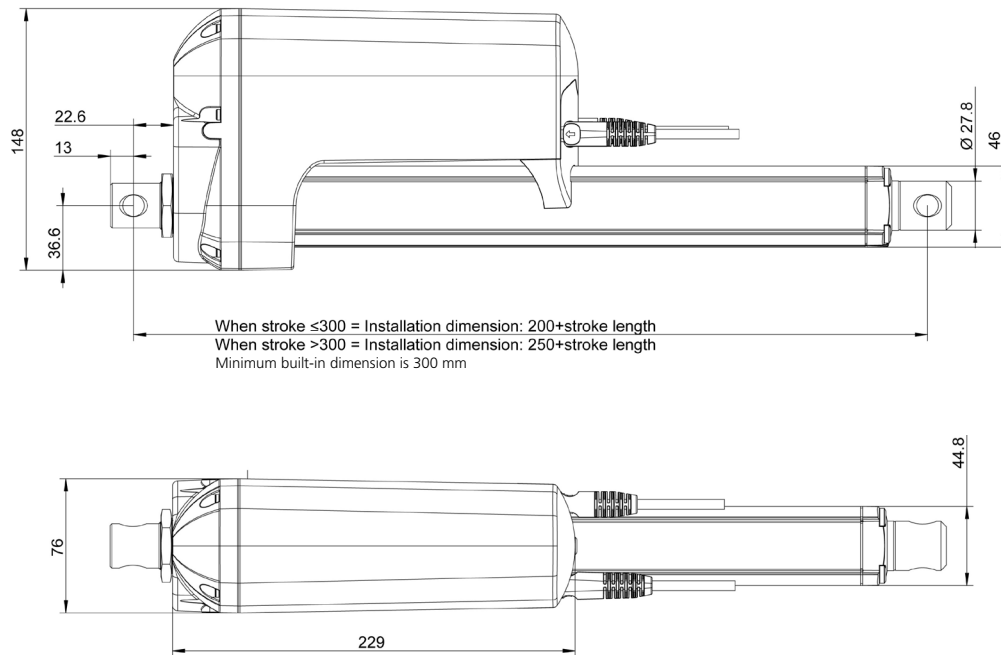

 The above dimensions apply for solid and slotted piston rod eyes and back fixtures.

Keep a clearance when mounting a bracket

 When mounting a custom bracket on the moving part of the actuator, please observe the minimum clearance between bracket and cylinder top, when fully retracted, to avoid jamming and destruction of actuator drive train.

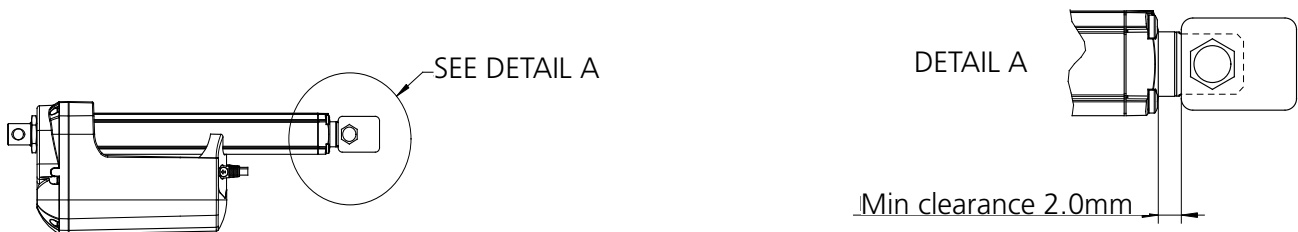

The Zero Point Initialisation Zone is located between 35-75 mm going from the most inward position.

The movement passing the zone has to be stable for the initialisation to succeed. No virtual limits can be set in the initialisation zone.

Electrical installation

-  When using soft stop on a DC-motor, the actuator can send a short high-voltage pulse to the power supply. It is important to make sure that it does not turn off the output when this backwards load dump occurs
- Deutsch DTP is to be used for power supply in 12 V applications due to the high current draw



The power supply for actuators without integrated controller must be monitored externally and cut off in case of current overload. IC actuators have an integrated overcurrent protection.

The current limiting algorithm

The Integrated Controller features the latest current limiting algorithm, which has been significantly improved compared to previous versions.

If the actuator's current consumption rises above the set limit, the actuator reduces speed to stay below the current limit. The actuator does this continuously, until the actuator stops moving (mechanically blocked) - something that is determined by monitoring the Hall feedback signal. If there are no changes to the Hall feedback signal during the set time frame, the integrated controller will cut power to the h-bridge motor circuit.

If the actuator is stopped due to the above-mentioned criteria, it automatically drives slightly in the opposite direction to reduce the torque in a blocking situation.

This is visualised in the figure below:

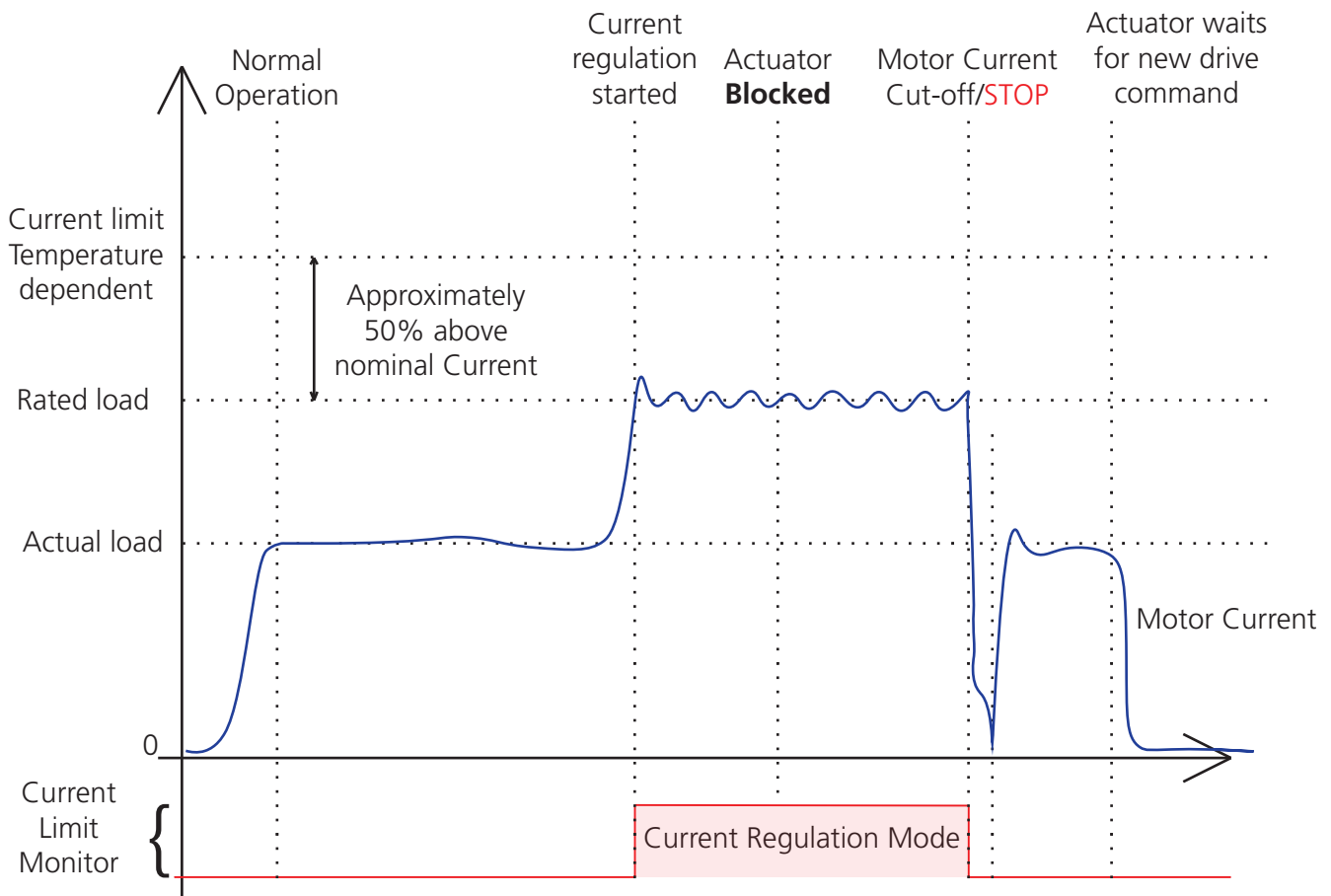

Figure 1

This control feature makes it possible to avoid loading the internal mechanical system of the actuator above its specification, which ultimately means a longer life for the actuator, especially in an abuse scenario.



The actuator comes with factory default current limits. These values can be customised with the 'Protection' option in Actuator Connect™ or when ordering the actuator.

Current limits

As described in the algorithm on previous page

Platform	24 V	48 V	Reference temperature: 0°C
All	13 A	8 A	Above
	26 A	13 A	Below

Cable mounting

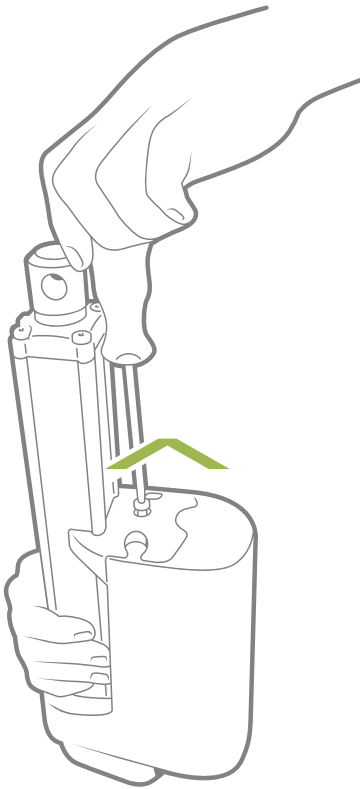

1. Unscrew the screw and separate the cover from the housing. Remove the blind plug(s).

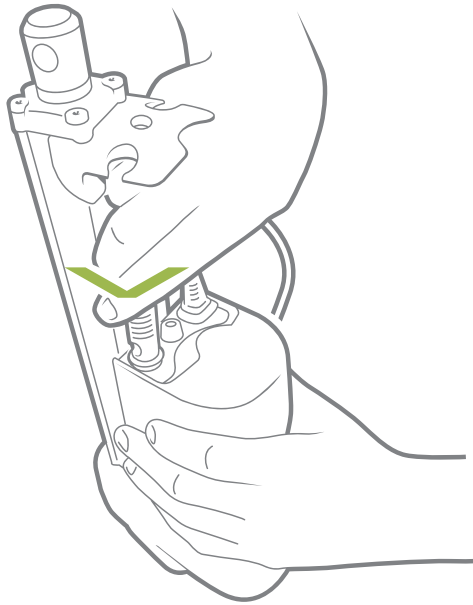

2. Plug in the power cable and/or the signal cable.

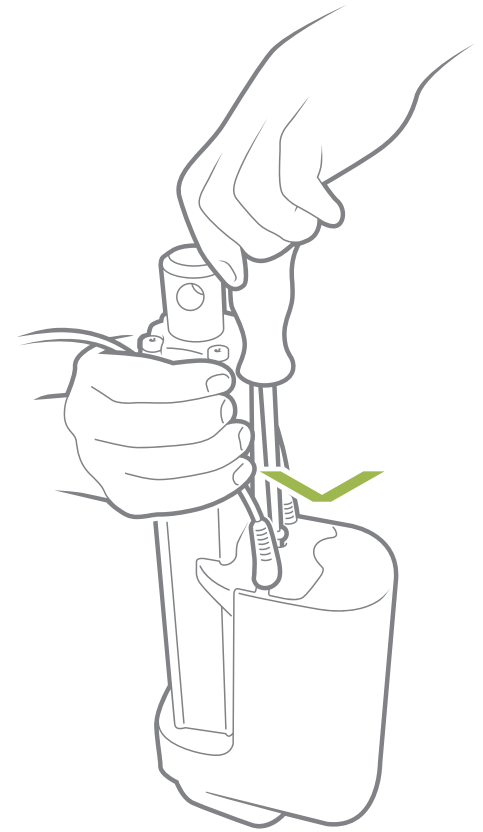

3. Slide the cover onto the actuator.

The torque of the cover screw is approx. 3.5 ± 0.3 Nm TORX 25IP



When changing the cables on a LINAK® actuator, it is important that this is done carefully, in order to protect the plugs and pins. Before the new cable is mounted, we recommend that the socket is greased with Vaseline®, to keep the high IP protection and ensure an easy mounting. Please be sure that the plug is in the right location and fully pressed in before the cable lid is mounted.

Cut off the tinned end if you connect the cable with screws. The tinned end is only to be used when a soldered connection is made.

Please note that if the cables are mounted and dismantled more than 3 times, the plugs can be damaged. Therefore, we recommend that such cables are discarded and replaced.

Do not lift the actuator by the cables.

We recommend taking some precaution and designing the wire connection in a way, where the cable end is kept inside a closed, protected area to guarantee the high IP protection.

Cable mounting

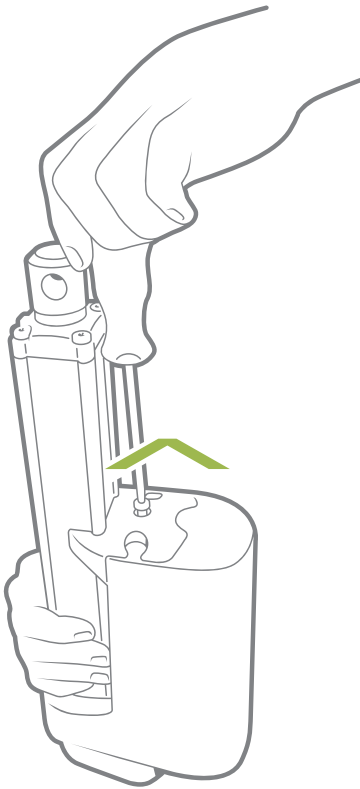

1. Unscrew the screw and separate the cover from the housing. Remove the blind plug(s).

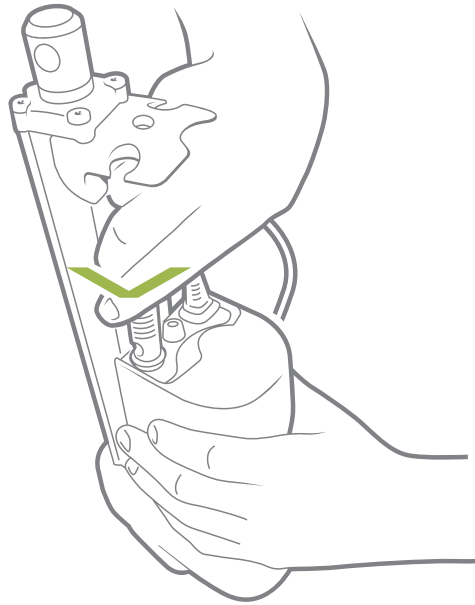

2. Plug in the power cable and/or the signal cable.

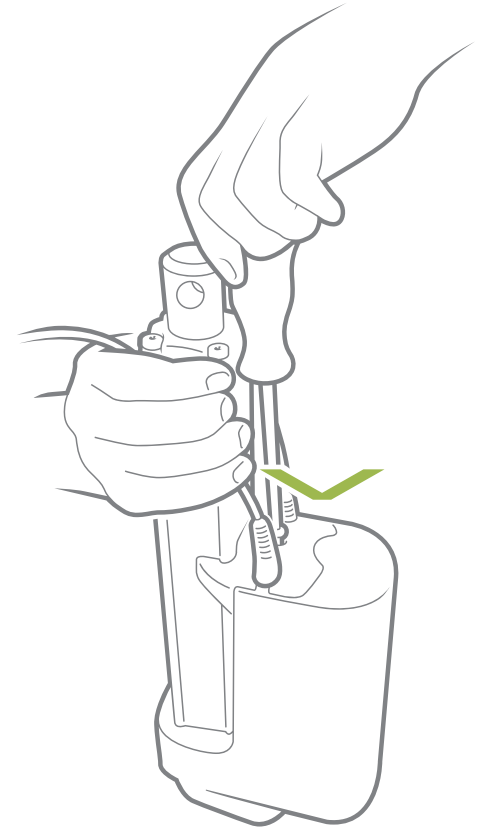

3. Slide the cover onto the actuator.

The torque of the cover screw is approx. 3.5 ± 0.3 Nm TORX 25IP



When changing the cables on a LINAK® actuator, it is important that this is done carefully, in order to protect the plugs and pins. Before the new cable is mounted, we recommend that the socket is greased with Vaseline®, to keep the high IP protection and ensure an easy mounting. Please be sure that the plug is in the right location and fully pressed in before the cable lid is mounted.

Cut off the tinned end if you connect the cable with screws. The tinned end is only to be used when a soldered connection is made.

Please note that if the cables are mounted and dismantled more than 3 times, the plugs can be damaged. Therefore, we recommend that such cables are discarded and replaced.

Do not lift the actuator by the cables.

We recommend taking some precaution and designing the wire connection in a way, where the cable end is kept inside a closed, protected area to guarantee the high IP protection.

Manual hand crank

The manual hand crank can be used in the case of a power failure -it is only intended for emergency use.

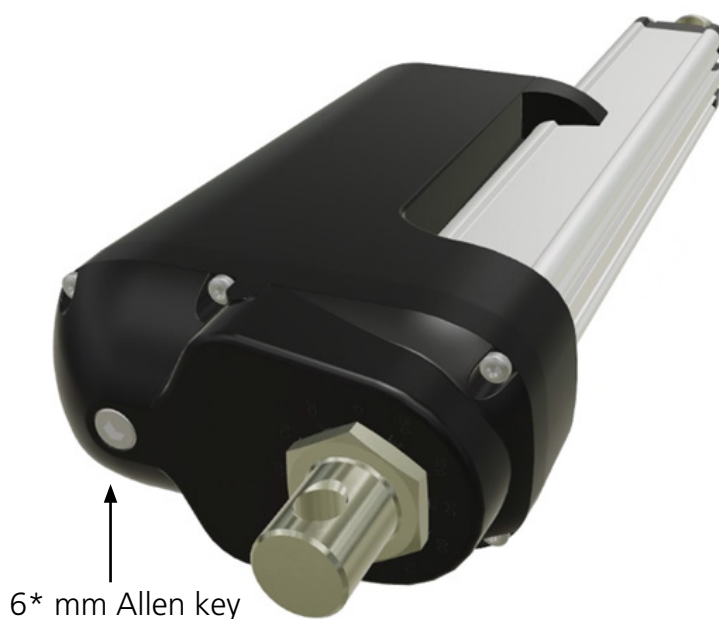

The cover over the Allen key socket must be unscrewed before the Allen key can be inserted and the hand crank operated.

Hand crank torque: 6-8 Nm

Hand crank RPM: Max. 65

Piston rod movement per turn:		
Spindle type:	12 mm	20 mm
Gear E	-	27 mm
Gear F	11 mm	18 mm
Gear G	6 mm	10 mm
Gear H	4 mm	7 mm

* 5 mm Allen key -if stainless steel piston rod eye and back fixture are chosen



- The power supply has to be disconnected during manual operation.
- If the actuator is operated as a hand crank, it must only be operated by hand - otherwise there is a potential risk of overloading and thereby damaging the actuator. Use your hand to turn the crank. Do not use power tools!
- After using the hand crank, the ingress protection IP66 cannot be maintained.
- Move the actuator to its starting position after using the crank. Failing to do so can damage the actuator or the application it is used for.
- Actuators with absolute positioning must be initialised after use of the manual hand crank, because their positioning will be displaced when the power is disconnected.

Label for LA76

LINAK® 

Designed in Denmark

DK - 6430 Nordborg

Type : 76120200A0F34B=614H30387ACS000

Item No. : 76XXXX-XX

Prod. Date : 2024.05.14

Max Load : Push 6800 N / Pull 6800 N IP66

Power Rate: 48 V^{DC}, Max. 8 A

Duty Cycle : 20%, Max 4 min. / 16 min.

Model : LA76IO ; FCC ID: XBE-LAXXIO ; IC: 12338B-LAXXIO



W/O# -0001

Made in Denmark



1. **Type: 76120200A0F34B-614H30387ACS000**
Describes the basic functionality of the product
2. **Item no.: 76XXXX-XX**
Sales and ordering code
3. **Prod. Date: YYYY.MM.DD**
Production date describes when the product has been produced. This date is the reference for warranty claims
4. **Max Load: Push 6800 N / Pull 6800 N IP66**
Describes the maximum load that the product can be exposed to in compression and tension. This line also contains a reference to the product's IP protection degree
5. **Power Rate: 48 V DC / Max. 8 Amp**
Input voltage for the product and maximum current consumption
6. **Duty Cycle: 20%, Max. 4 min. / 16 min.**
The duty cycle defines the maximum period during operation without interruption. After operation, a pause must be observed. It is important that the operator follows the instructions of the duty cycle; otherwise, a possible overload may result in reduced product life/errors
7. **W/O: #12345678 -0001**
The LINAK work order followed by a unique sequential identification number

Maintenance

- The actuator must be cleaned at regular intervals to remove dust and dirt and inspected for mechanical damages or wear.
- Inspect attachment points, wires, piston rod, cabinet, and plug, as well as check that the actuator functions correctly.
- To ensure that the pre-greased inner tube remains lubricated, the actuator must only be washed down when the piston rod is fully retracted.
- The actuator is a closed unit and therefore requires no internal maintenance.
- In order to maintain a proper performance of the spherical eyes and to increase the resistance against environmental wear, we strongly recommend that the spherical eyes (ball bearings) mounted on actuators from LINAK® are greased with anticorrosive grease or similar.

Repair

See warranty disclaimer.

Main groups of disposal

LINAK's products may be disposed of, possibly by dividing them into different waste groups for recycling or combustion.

We recommend that our product is disassembled as much as possible at the disposal and that you try to recycle it.

Product	Metal scrap	Cable scrap	Electronic scrap	Plastic recycling or combustion
LA76	X	X	X	X

Warranty

There is an 18 months' warranty on TECHLINE® products against manufacturing faults calculated from the production date of the individual products (see label). LINAK's warranty is only valid in so far as the equipment has been used and maintained correctly and has not been tampered with. Furthermore, the actuator must not be exposed to violent treatment. In the event of this, the warranty will be ineffective/invalid. For further details, please see standard terms of sale and delivery for LINAK A/S.

Note

Only an authorised LINAK service centre should repair LINAK actuator systems. Systems to be repaired under warranty must be sent to an authorised LINAK service centre.

In order to avoid the risk of malfunction, all actuator repairs must only be carried out by an authorised LINAK Service shop or repairer, as special tools and parts must be used.

If a system is opened by unauthorised personnel there is a risk that it may malfunction at a later date.

The actuator is not to be opened by unauthorised personnel. In case the actuator is opened, the warranty will be invalid.

DECLARATION OF INCORPORATION OF PARTLY COMPLETED MACHINERY

LINAK A/S
Smedevænget 8
DK - 6430 Nordborg

LINAK A/S hereby declares that LINAK DESKLINE® products, characterised by the following models and types:

Control Boxes	CBD6S
Linear Actuators	DB5, DB6, DB14, LA23, LA31
Lifting Columns	DL1A, DL2, DL4S, DL5, DL6, DL8, DL9, DL10, DL11, DL12, DL14, DL15, DL16, DL17, DL18, DL19, DL20, DL21, BASE1, LC1
Desk Panels	DPA, DPB, DPH, DPF, DPG, DPT, DP, DP1CS, DPI
Wireless Controls	BP10
Frames and Feet	Kick & Click, DF2, DF3, DLF
Accessories	BA001, BLE2LIN, CHUSB, DESK Sensor, SLS, SMPS, USB2LIN, WiFi2LIN, DC Connector, RFRL

LINAK A/S hereby declares that LINAK HOMELINE® products, characterised by the following models and types:

Control Boxes	CBD6DC
Linear Actuators	LA10, LA18, LA40 HOMELINE
Dual Actuators	TD4, TD5
Controls	BP10, HC10, HC20, HC40
Accessories	BA002, CP, BLE2DC, BLE2LIN, LED Light Rail, MD1, SMPS, WiFi2LIN

LINAK A/S hereby declares that LINAK MEDLINE® & CARELINE® products, characterised by the following models and types:

Control Boxes	CA10, CA20, CA30, CA40, CA63, CAL40, CB6, CB6S, CB6P2, CB8, CB9, CBJ2, CBJ Care, CBJ Home, CO41, CO53, CO61, CO65, CO71, COL50, OPS, PJ2
Linear Actuators	KA19, KA30, KA30 ICA, LA20, LA23, LA24, LA24 ICA, LA27, LA28, LA29, LA30, LA31, LA34, LA40, LA42, LA44
Lifting Columns	BL1, LC1, LC3
Controls	ABL, ACC, ACK, ACO, ACOD, ACOM, ACL, DP, DPH, FS, FS3, FPP, HB30, HB70, HB80, HB100, HB190, HB200, HB400, HD80, HL70, HL400, SC01
Accessories	BA15, BA16, BA18, BA19, BA22, BAJ, BAJL, BAL40, BAL50, CH01, CHJ2, CHL40, CHL50, DJB, LIN2OB, MJB2, MJB5 Plus, Massage Motor, PJB4, QLCI2, SLS, SMPS10, UBL, UBL2, UBL4 Motion, USB-A Power Adapter

LINAK A/S hereby declares that LINAK TECHLINE® products, characterised by the following models and types:

Linear Actuators	LA12, LA14, LA21, LA23, LA25, LA30, LA33, LA35, LA36, LA37, LA73, LA76, LA77
Lifting Columns	LC3 IC
Accessories	FMB

comply with the following parts of the Machinery Directive 2006/42/EC, ANNEX I, Essential health and safety requirements relating to the design and construction of machinery: 1.5.1 Electricity supply

The relevant technical documentation is compiled in accordance with part B of Annex VII and this documentation or part hereof will be transmitted by post or electronically to a reasoned request by the national authorities.

This partly completed machinery must not be put into service until the final machinery into which it is to be incorporated has been declared in conformity with the provisions of the Machinery Directive 2006/42/EC where appropriate.

Nordborg, 2025-07-04



LINAK A/S

John Kling, B.Sc.E.E., Certification and Regulatory Affairs

Authorised to compile the relevant technical documentation

Contacts

FACTORIES

Denmark - Headquarters
LINAK A/S
Phone: +45 73 15 15 15
Fax: +45 74 45 80 48
Fax (Sales): +45 73 15 16 13
Web: www.linak.com

China
LINAK (Shenzhen) Actuator Systems, Ltd.
Phone: +86 755 8610 6656
Fax: +86 755 8610 6990
Web: www.linak.cn

Slovakia
LINAK Slovakia s.r.o.
Phone: +421 51 7563 444
Web: www.linak.sk

Thailand
LINAK APAC Ltd.
Phone: +66 33 265 400
Web: www.linak.com

USA
LINAK U.S. Inc.
Americas Headquarters
Phone: +1 502 253 5595
Fax: +1 502 253 5596
Web: www.linak-us.com
www.linak-latinamerica.com

SUBSIDIARIES

Australia
LINAK Australia Pty. Ltd
Phone: +61 3 8796 9777
Fax: +61 3 8796 9778
E-mail: sales@linak.com.au
Web: www.linak.com.au

Austria
LINAK Zweigniederlassung - Österreich (Wien)
Phone: +43 (1) 890 7446
Fax: +43 (1) 890 744615
E-mail: info@linak.de
Web: www.linak.at - www.linak.hu

Belgium
LINAK Actuator-Systems NV/SA
(Belgium & Luxembourg)
Phone: +32 (0)9 230 01 09
E-mail: beinfo@linak.be
Web: www.linak.be - www.fr.linak.be

Brazil
LINAK Do Brasil Comércio De Atuadores Ltda.
Phone: +55 (11) 2832 7070
Fax: +55 (11) 2832 7060
E-mail: info@linak.com.br
Web: www.linak.com.br

Canada
LINAK Canada Inc.
Phone: +1 502 253 5595
Fax: +1 416 255 7720
E-mail: info@linak.ca
Web: www.linak-us.com

Czech Republic
LINAK C&S s.r.o.
Phone: +42 058 174 1814
Fax: +42 058 170 2452
E-mail: info@linak.cz
Web: www.linak.cz - www.linak.sk

Denmark - International
LINAK International
Phone: +45 73 15 15 15
E-mail: info@linak.com
Web: www.linak.com

Denmark - Sales
LINAK Danmark A/S
Phone: +45 86 80 36 11
Fax: +45 86 82 90 51
E-mail: linak@linak-silkeborg.dk
Web: www.linak.dk

Finland
LINAK OY
Phone: +358 10 841 8700
E-mail: linak@linak.fi
Web: www.linak.fi

France
LINAK France E.U.R.L.
Phone: +33 (0) 2 41 36 34 34
Fax: +33 (0) 2 41 36 35 00
E-mail: linak@linak.fr
Web: www.linak.fr

Germany
LINAK GmbH
Phone: +49 6043 9655 0
Fax: +49 6043 9655 60
E-mail: info@linak.de
Web: www.linak.de

India
LINAK A/S India Liaison Office
Phone: +91 120 4531797
Fax: +91 120 4786428
E-mail: info@linak.in
Web: www.linak.in

Ireland
LINAK UK Limited (Ireland)
Phone: +44 (0)121 544 2211
Fax: +44 (0)121 544 2552
+44 (0)796 855 1606 (UK Mobile)
+35 387 634 6554 (Rep.of Ireland Mobile)
E-mail: sales@linak.co.uk
Web: www.linak.co.uk

Italy
LINAK ITALIA S.r.l.
Phone: +39 02 48 46 33 66
Fax: +39 02 48 46 82 52
E-mail: info@linak.it
Web: www.linak.it

Japan
LINAK K.K.
Phone: 81-45-533-0802
Fax: 81-45-533-0803
E-mail: linak@linak.jp
Web: www.linak.jp

Malaysia
LINAK Actuators Sdn. Bhd.
Phone: +60 4 210 6500
Fax: +60 4 226 8901
E-mail: info@linak-asia.com
Web: www.linak.my

Netherlands
LINAK Actuator-Systems B.V.
Phone: +31 76 5 42 44 40 /
+31 76 200 11 10
E-mail: info@linak.nl
Web: www.linak.nl

New Zealand
LINAK New Zealand Ltd
Phone: +64 9580 2071
Fax: +64 9580 2072
E-mail: nzsales@linak.com.au
Web: www.linak.com.au

Norway
LINAK Norge AS
Phone: +47 32 82 90 90
E-mail: info@linak.no
Web: www.linak.no

Poland
LINAK Polska
LINAK Danmark A/S (Spółka Akcyjna)
Phone: +48 22 295 09 70 /
+48 22 295 09 71
E-mail: info@linak.pl
Web: www.linak.pl

Republic of Korea
LINAK Korea Ltd.
Phone: +82 2 6231 1515
Fax: +82 2 6231 1516
E-mail: info@linak.kr
Web: www.linak.kr

Slovakia
LINAK Slovakia S.R.O.
Phone: +421 51 7563 444
Web: www.linak.sk

Spain
LINAK Actuadores, S.L.u
Phone: +34 93 588 27 77
Fax: +34 93 588 27 85
E-mail: esma@linak.es
Web: www.linak.es

Sweden
LINAK Scandinavia AB
Phone: +46 8 732 20 00
Fax: +46 8 732 20 50
E-mail: info@linak.se
Web: www.linak.se

Switzerland
LINAK AG
Phone: +41 43 388 31 88
E-mail: info@linak.ch
Web: www.linak.ch - www.fr.linak.ch
www.it.linak.ch

Taiwan
LINAK (Shenzhen) Actuator systems Ltd.
Taiwan Representative office
Phone: +886 2 272 90068
Fax: +886 2 272 90096
E-mail: sales@linak.com.tw
Web: www.linak.com.tw

Turkey
LINAK İth. İhr. San. ve Tic. A.Ş.
Phone: +90 312 4726338
Fax: +90 312 4726635
E-mail: info@linak.com.tr
Web: www.linak.com.tr

United Kingdom
LINAK UK Limited
Phone: +44 (0)121 544 2211
Fax: +44 (0)121 544 2552
E-mail: sales@linak.co.uk
Web: www.linak.co.uk

Argentina
Novotec Argentina SRL
Phone: 011-4303-8989 / 8900
Fax: 011-4032-0184
E-mail: info@novotecargentina.com
Web: www.novotecargentina.com

Colombia
MEM Ltda
Phone: +[57] (1) 334-7666
Fax: +[57] (1) 282-1684
E-mail: servicioalcliente@memltda.com.co
Web: www.mem.net.co

India
Mechatronics Control Equipments India Pvt Ltd
Phone: +91-44-28558484, 85
E-mail: bala@mechatronicscontrol.com
Web: www.mechatronicscontrol.com

Indonesia
PT. Himalaya Everest Jaya
Phone: +6 221 544 8956 /+6 221 544 8965
Fax: +6 221 619 1925
Fax (Sales): +6 221 619 4658
E-mail: hejplastic-div@centrin.net.id
Web: www.hej.co.id

Israel
NetivTech LTD
Phone: +972 55-2266-535
Fax: +972 2-9900-560
Email: info@NetivTech.com
Web: www.netivtech.com

Singapore
Servo Dynamics Pte Ltd
Phone: +65 6844 0288
Fax: +65 6844 0070
E-mail: servodynamics@servo.com.sg

South Africa
Industrial Specialised Applications CC
Phone: +27 011 466 0346
E-mail: gartht@isagroup.co.za
Web: www.isaza.co.za

United Arab Emirates
Mechatronics
Phone: +971 4 267 4311
Fax: +971 4 267 4312
E-mail: mechtron@emirates.net.ae

DISTRIBUTORS